

375-B-1

Doc # 000535588  
PK # 908 TS # 03

**UNIT AREAS:**

UNIT #1  
FIRST FLOOR = 1,560 S.F.  
SECOND FLOOR = 1,276 S.F.

UNIT #2  
FIRST FLOOR = 1,540 S.F.  
SECOND FLOOR = 1,710 S.F.

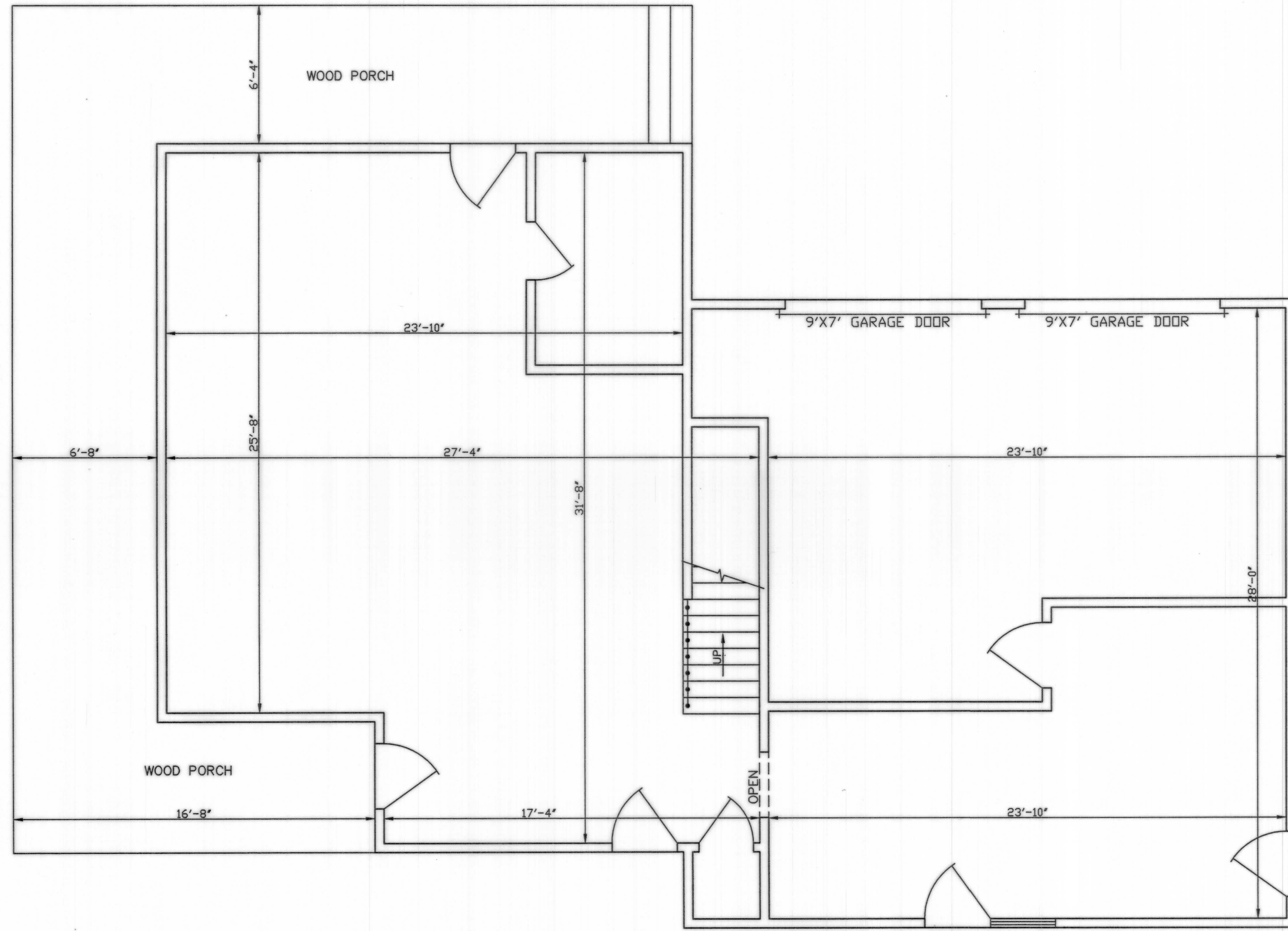

WILLIAM MUNGER, MEMBER OF FREEBODY, LLC  
HEREBY CONSENTS TO THE RECORDING OF THIS  
SURVEY MAP PURSUANT TO CHAPTER 34-36.1 (RHODE  
ISLAND CONDOMINIUM ACT) OF THE GENERAL LAWS OF  
RHODE ISLAND.

OWNER: WILLIAM MUNGER, MEMBER OF FREEBODY, LLC

BY: *William Munger* DATE: 10/10/17

STATE OF RHODE ISLAND, COUNTY OF NEWPORT, TOWN  
OF JAMESTOWN ON THIS 10<sup>TH</sup> DAY OF OCTOBER  
2017 BEFORE ME PERSONALLY APPEARED WILLIAM  
MUNGER, TO ME KNOWN AND BY ME TO BE THE  
PERSON EXECUTING THE FOREGOING CONSENT AND HE  
ACKNOWLEDGED SAID INSTRUMENT TO BE HIS FREE  
ACT AND DEED INDIVIDUALLY AND IN SAID CAPACITY  
AND THE FREE ACT AND DEED OF WILLIAM MUNGER.

NOTARY PUBLIC: *Michael R. Darveau*

MY COMMISSION EXPIRES: 10/14/21

I HEREBY CERTIFY THAT THIS CONDOMINIUM PLAN CONTAINS ALL OF THE INFORMATION  
REQUIRED BY THE R.I.G.L. 34-36.1-2.09 "RHODE ISLAND CONDOMINIUM ACT", AND THAT THE  
PROPERTY HAS BEEN SURVEYED ON THE GROUND, CLOSED AND IS CORRECT.

THIS SURVEY HAS BEEN CONDUCTED AND THE PLAN HAS BEEN PREPARED PURSUANT TO  
SECTION 9 OF THE RULES AND REGULATIONS ADOPTED BY THE RHODE ISLAND STATE BOARD  
OF REGISTRATION FOR PROFESSIONAL LAND SURVEYORS ON NOVEMBER 25, 2015, AS FOLLOWS:

TYPE OF SURVEY: DATA ACCUMULATION SURVEY MEASUREMENT SPECIFICATION: CLASS III

STATEMENT OF PURPOSE:  
THE PURPOSE FOR THE CONDUCT OF THE SURVEY AND FOR THE PREPARATION OF THE PLAN  
IS AS FOLLOWS:

- 1) PREPARE A CONDOMINIUM FLOOR PLAN.

BY: *Michael R. Darveau* DATE: 10/16/17  
MICHAEL R. DARVEAU, PLS#1978  
PRESIDENT, DARVEAU LAND SURVEYING, INC. COA #LS-A497



**EXISTING UNIT #2  
FIRST FLOOR PLAN**  
SCALE: 1/4" = 1'-0"

RECORDED FOR RECORD  
OCT 17 2017 02:59P  
TOWN CLERK  
A. FERNSTROM

**DARVEAU LAND SURVEYING, INC.**  
P.O. BOX 7918  
CUMBERLAND, R.I. 02864  
PHONE 401-475-5700  
E-MAIL: MIKE@DARVEAUSURVEY.COM

CONDOMINIUM FLOOR PLAN FOR  
**ISLAND PLACE CONDOMINIUMS**  
PLAT 8, LOT 493  
230 CONANICUS AVENUE  
JAMESTOWN, RHODE ISLAND

PROJECT NO: 2013_035	REVISION	SCALE: 1/4" = 1'-0"
SHEET NO: 4 OF 5	DATE: OCT. 16, 2017	DRAWN BY: S.A.K.