

LOCUS MAP
NOT TO SCALE
BEING A.P. 8, LOT 3
TOTAL AREA OF LOT = 10,000 SF

- REFERENCES:**
1. REFERENCE IS HEREBY MADE TO THAT PLAN ENTITLED "PLAT OF LANDS AT WEST FERRY, JAMESTOWN, R.I." PREPARED BY R.J. EASTON & SON, DATED AUGUST 13, 1929 SCALE 1"=20' RECORDED IN THE LAND EVIDENCE RECORDS AS PLAT 155A.
 2. REFERENCE IS HEREBY MADE TO THAT PLAN ENTITLED "PLAT OF LAND IN JAMESTOWN TO BE CONVEYED BY VIERA TO SHIPPEE" BY EDWARD E. NEWMAN, DATED 1954 SCALE 1"=20' RECORDED IN THE LAND EVIDENCE RECORDS IN BOOK 46, PG 323.
 3. REFERENCE IS HEREBY MADE TO THAT PLAN ENTITLED "PLAT OF LAND OF ALBERT ANDERSON JR. LOCATED IN THE TOWN OF JAMESTOWN" BY RAYMOND W. SCHWAB DATED 4/22/65 SCALE 1"=30' RECORDED IN LAND EVIDENCE RECORDS AS PLAT 269A.
 4. REFERENCE IS HEREBY MADE TO THAT PLAN ENTITLED "PLAN OF LAND DUTCH HARBOR BOAT YARD" BY NORTHEAST ENGINEERS & CONSULTANTS INC. DATED 07/13/01 SCALE 1"=30' RECORDED IN LAND EVIDENCE RECORDS AS PLAT 177B.
 5. REFERENCE IS HEREBY MADE TO THAT PLAN ENTITLED "PLAN OF LAND IN JAMESTOWN, R.I. PREPARED FOR FRANK NEWMAN" BY ISLAND ENGINEERING DATED 7/20/88 SCALE 1"=20' RECORDED IN LAND EVIDENCE RECORDS AS PLAT 66A.

DETAIL "A"
NOT TO SCALE

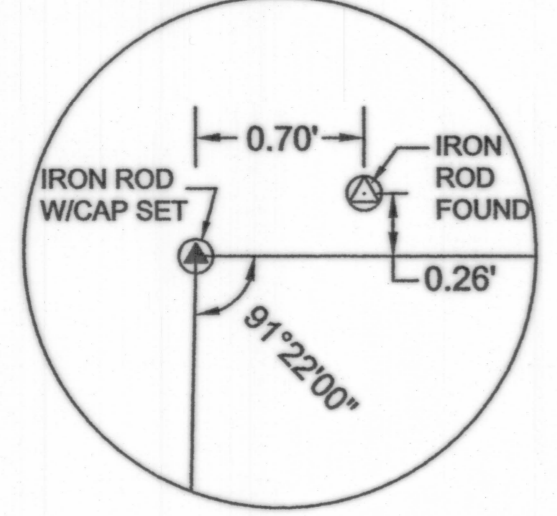

DETAIL "B"
NOT TO SCALE

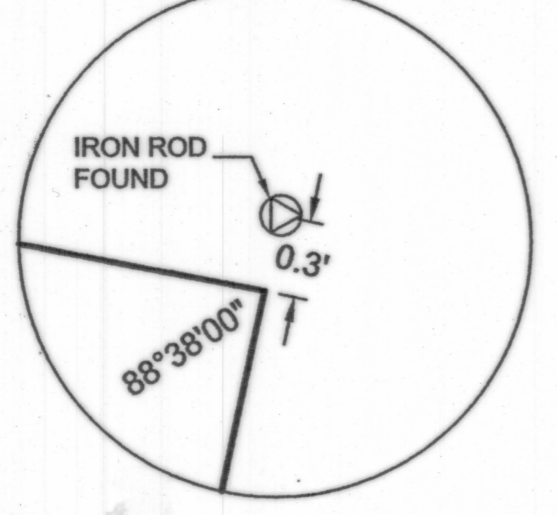

DETAIL "C"
NOT TO SCALE

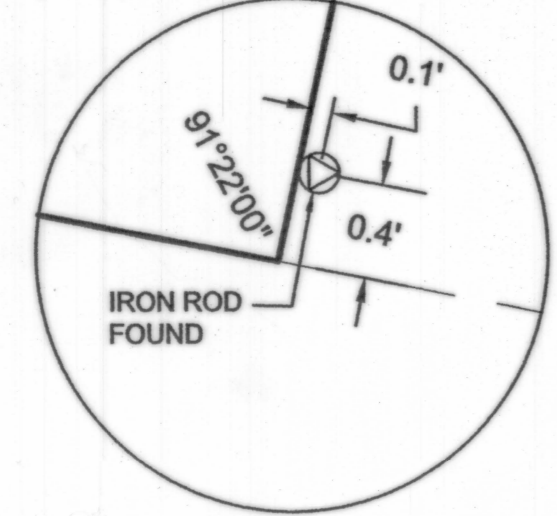

THE PERIMETER SURVEY AND PLAN CONFORMS TO A CLASS I STANDARD AS ADOPTED BY THE RHODE ISLAND BOARD OF REGISTRATION FOR PROFESSIONAL LAND SURVEYORS.

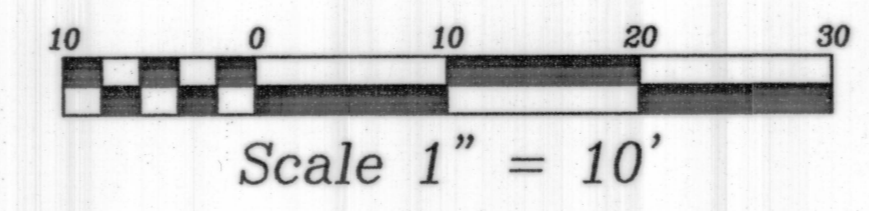

BY: *[Signature]* 11/25/14
REGISTERED PROFESSIONAL LAND SURVEYOR DATE

THIS PLAN IS TO BE INDEXED UNDER THE FOLLOWING ROADS:
1. AVENUE B

PLAN OF LAND FOR
MARK VENABLE
LOCATED AT
17 AVENUE B
JAMESTOWN, R.I.

Drawn By: JPL Checked By: DrC
Scale: 1" = 10' Date: 11/18/2014

NO.	REVISION	BY	DATE

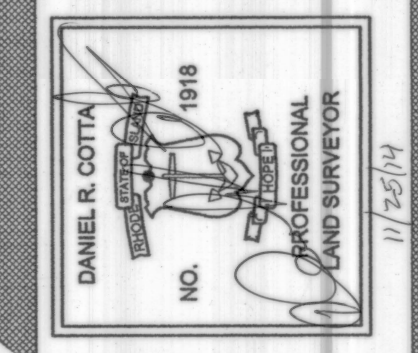

AMERICAN ENGINEERING, INC.
DANIEL R. COTTA Professional Engineer / Professional Land Surveyor
400 South County Trail - Suite A 201
Exeter, Rhode Island 02822
Phone (401) 294-4090 / Fax (401) 294-3625

Sheet
1
of 1 sheets
Drawing No. 114186