

HPF234A

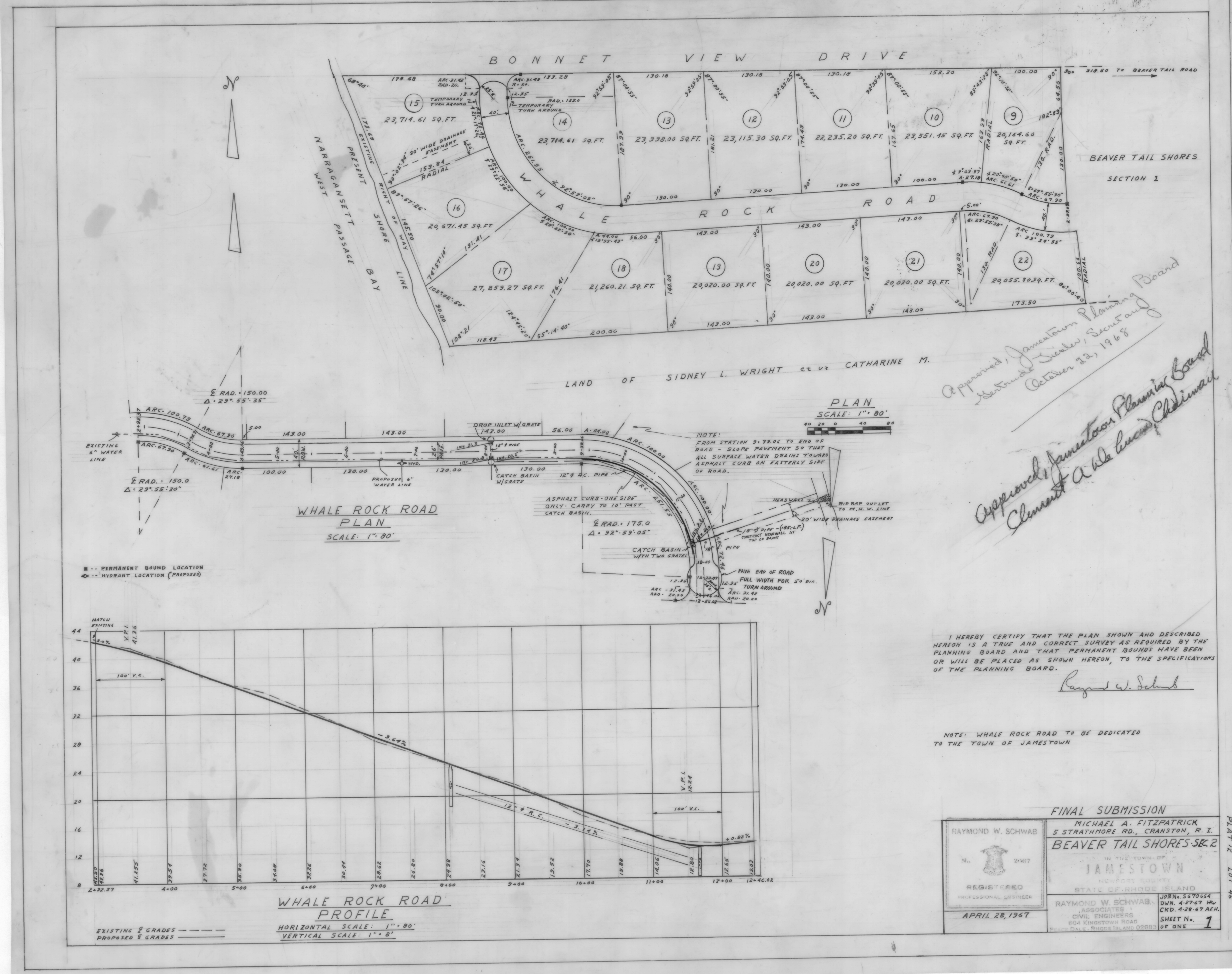

Approved, Jamestown Planning Board
 October 23, 1968
 Approved, Jamestown Planning Board
 Clement A. de Luca, Chairman

I HEREBY CERTIFY THAT THE PLAN SHOWN AND DESCRIBED HEREON IS A TRUE AND CORRECT SURVEY AS REQUIRED BY THE PLANNING BOARD AND THAT PERMANENT BOUNDS HAVE BEEN OR WILL BE PLACED AS SHOWN HEREON, TO THE SPECIFICATIONS OF THE PLANNING BOARD.
 Raymond W. Schwab

NOTE: WHALE ROCK ROAD TO BE DEDICATED TO THE TOWN OF JAMESTOWN

PLAT 12 LOT 46