

HPF #231A

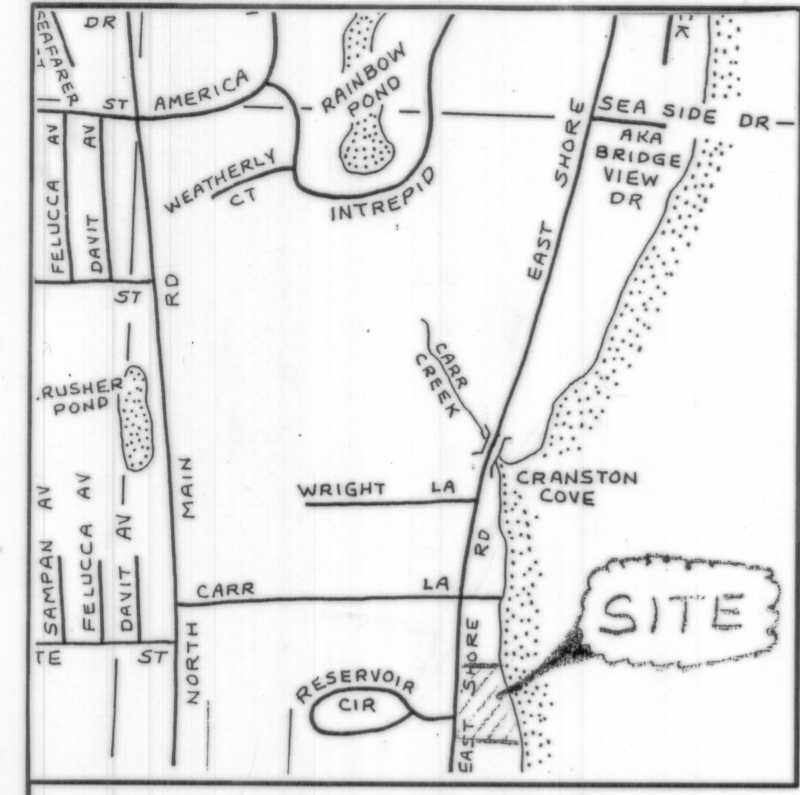

LOCUS NOT TO SCALE

STREET INDEX EAST SHORE ROAD

DEED REFERENCES: LOT 10 - DEED BOOK 87 AT PAGE 166. LOT 50 - DEED BOOK 629 AT PAGE 132. LOT 145 - DEED BOOK 315 AT PAGE 83. PLAN REFERENCES: ALTERNATIVE PROPOSED SUBDIVISION, LOT 10, A.P. 4 OWNED BY WILLIAM & VIRGINIA PRITCHETT, DATED: DEC., 1986" BY ISLAND ENGINEERING AND RECORD IN THE TOWN OF JAMESTOWN REGISTRY OF DEEDS ON HANGING PLAT FILE NO. 29A.

- NOTES: 1. PARCELS A & B COMPRISE ALL OF PLAT 4, LOT 145. 2. PLAT 4, LOT 10 & 145 OWNED BY: DAVID E. ROOSA & JILL OLIVEIRA ROOSA 340 EAST SHORE ROAD JAMESTOWN, R.I. 02835 3. THE EXISTING DWELLING ADDRESS ON PLAT 4, LOT 10 IS 340 EAST SHORE ROAD. 4. AREA IS ZONED: RR-80

EAST SHORE ROAD (PUBLIC - IMPROVED - VARIABLE WIDTH)

NARRAGANSETT BAY

PLAT 4, LOT 33 N/F EASTWARD VISTA, LLC (BOOK 491 AT PAGE 62)

PLAT 4, LOT 50 OLD AREA = 139,620± S.F. OR 3.20± ACRES NEW AREA = 186,730± S.F. OR 4.29± ACRES

PARCEL A AREA = 47,110± S.F.

PARCEL B AREA = 31,763 S.F.

PLAT 4, LOT 10 OLD AREA = 225,830± S.F. OR 5.18± ACRES NEW AREA = 257,593± S.F. OR 5.91± ACRES

PLAT 4, LOT 137 N/F STEPHEN EVANGELISTA (BOOK 384 AT PAGE 179)

I APPROVE OF THE LOT LINE CHANGES AS SHOWN ON THIS PLAN. BY: Jill Oliveira Roosa, David E. Roosa, ROGER A. PETERS, II Authorized Representative for Barn and House, LLC

TOWN OF JAMESTOWN FINAL APPROVAL ADMINISTRATIVE SUBDIVISION Date: May 5, 2008 By: Robert C. Cournoyer

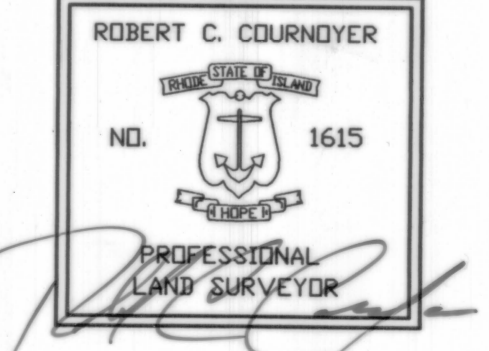

I HEREBY CERTIFY THAT THIS SURVEY AND PLAN CONFORMS TO A CLASS 1 STANDARD AS ADOPTED BY THE RHODE ISLAND BOARD OF REGISTRATION FOR PROFESSIONAL LAND SURVEYORS.

BY: Robert C. Cournoyer 4/29/08 DATE ROBERT C. COURNOYER, PLS#1615

THE PURPOSE OF THIS PLAN IS TO ADD AN APPROXIMATELY 65-FOOT WIDE STRIP OF PLAT 4, LOT 145 INTO PLAT 4, LOT 50. THE REMAINDER OF PLAT 4, LOT 145 IS TO BE ADDED TO PLAT 4, LOT 10. THE NET RESULT OF THIS SUBDIVISION IS THREE LOTS ARE COMBINED INTO TWO LOTS.

- LEGEND GB GRANITE BOUND FND FOUND I.P. IRON PIPE N/F NOW OR FORMERLY S.F. SQUARE FEET MHW MEAN HIGH WATER LINE

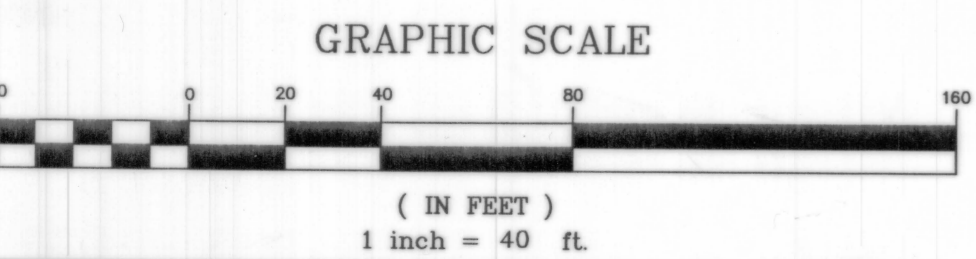

Administrative Subdivision Plan for DAVID E. ROOSA & JILL OLIVEIRA ROOSA & BARN AND HOUSE, LLC. Includes drawing and sheet numbers, scale, date, and contact information for RC Cournoyer Enterprises, Inc.