

DR.213 SH.74
BK: 126 PG: 311
C:\vacancies\work\2000\000251.dwg Thu Jun 13 14:28:34 2002

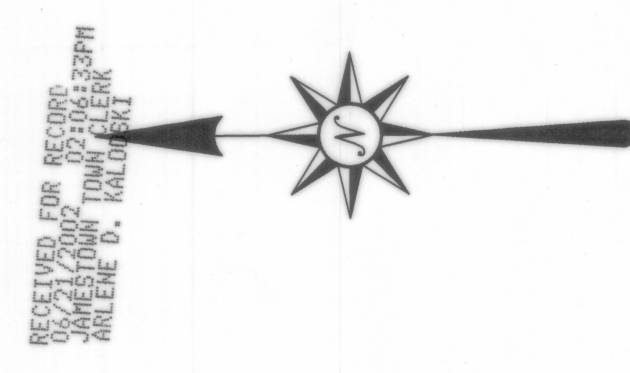

Received for record in Jamestown, R.I.
June 21, 2002 at 02:10:06 PM
Oliver DeBorja Town Clerk

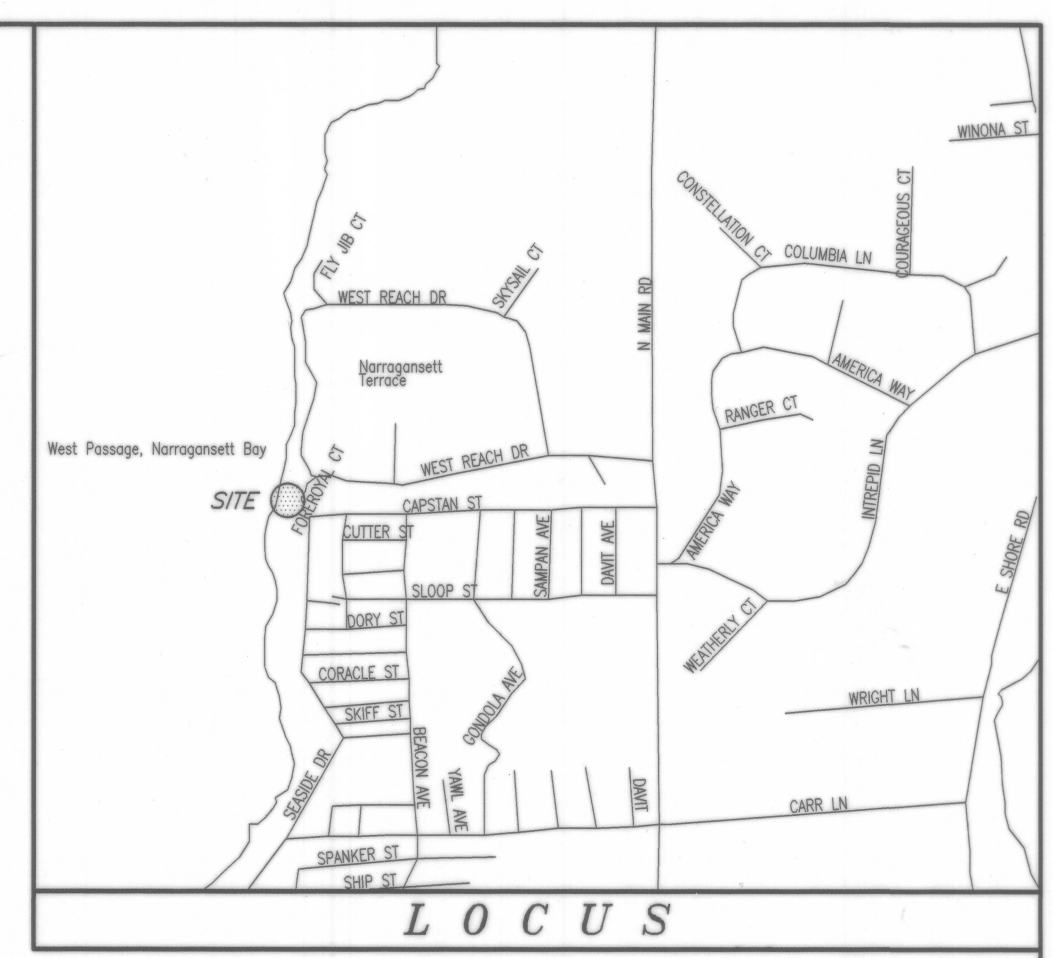

NOTES & REFERENCES

- REFERENCE IS MADE TO THE FOLLOWING PLANS AND MAPS:
 - WEST REACH ESTATES TOWN OF JAMESTOWN, RHODE ISLAND OWNER: COMMERCE OIL REFINING CORP. PATRICK E. BRADY, LANDSCAPE ARCHITECT NOV. 15, 1978.
- REFERENCE IS MADE TO THE FOLLOWING TOWN OF JAMESTOWN, RHODE ISLAND LAND EVIDENCE RECORDS REGARDING RECORD TITLE TO THE PREMISES SURVEYED;
 - LOT 3 - VOLUME 292 PAGE 32 - NICHOLAS R. & LINDA M. SUPRON
- THESE PREMISES MAY BE SUBJECT TO THE FOLLOWING RIGHTS OF WAY OR EASEMENTS OF RECORD:
 - VOLUME 292 PAGE 32 - RIGHTS IN COMMON W/ OTHERS TO USE FOOTPATHS FROM FORE ROYAL COURT AND FLY JIB COURT TO THE WATERS OF NARRAGANSETT BAY
 - 20' WIDE DRAINAGE EASEMENT AS SHOWN ON THE PLAT REFERENCED IN NOTE 1A.
 - RIGHTS OF OTHERS IN AND TO THE WATERS OF NARRAGANSETT BAY BOUNDED THESE PREMISES.
- THESE PREMISES MAY BENEFIT FROM THE FOLLOWING RIGHTS OF WAY OR EASEMENTS OF RECORD;
 - VOLUME 292 PAGE 32 - RIGHTS IN COMMON W/ OTHERS TO USE FOOTPATHS FROM FORE ROYAL COURT AND FLY JIB COURT TO THE WATERS OF NARRAGANSETT BAY
 - VOLUME 292 PAGE 32 - APPURTENANT INTERESTS IN LOTS 53, 54, ROSAMOND POND & TEFFT POND AS LAID OUT ON THE PLAT REFERENCED IN NOTE 1A.

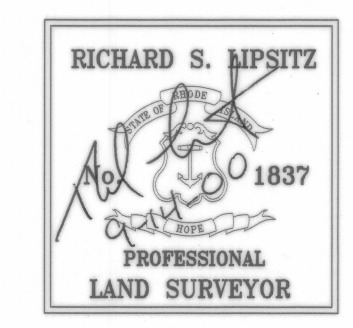
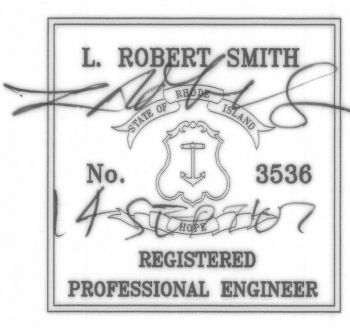

CERTIFICATION

THIS SURVEY AND PLAN CONFORM TO THE FOLLOWING CLASS STANDARDS AS ADOPTED BY THE RHODE ISLAND BOARD OF REGISTRATION FOR PROFESSIONAL LAND SURVEYORS, EFFECTIVE APRIL 1, 1994.

BOUNDARY SURVEY - CLASS I
TOPOGRAPHIC SURVEY CLASS N/A

[Signature] 1837 9-14-00
RICHARD S. LIPSITZ REG. NO. DATE
WATERMAN ENGINEERING COMPANY

LEGEND

N/F	- NOW OR FORMERLY	PK NAIL	- MASONRY NAIL
A.P.	- ASSESSORS PLAT	PED.	- PEDESTRIAN
DH	- DRILL HOLE	RHHB	- RHODE ISLAND HIGHWAY BOUND
(FND.)	- FOUND	FE	- FLARED END
±	- PLUS OR MINUS	RCP	- REINFORCED CONCRETE PIPE
S.F.	- SQUARE FEET	x 10.8	- SPOT GRADE
○○○○	- STONE WALL	-15-	- EXISTING CONTOUR
---	- FENCE	INV.	- INVERT
STY.	- STORY	□ CB	- CATCH BASIN
AC.	- ACRES	○	- SANITARY SEWER MANHOLE
W/F	- WOOD FRAMED	○	- STORM DRAIN MANHOLE
SHP	- STATE HIGHWAY PLAT	○	- ELECTRIC HANDHOLE
R/W	- RETAINING WALL	○	- WATER GATE

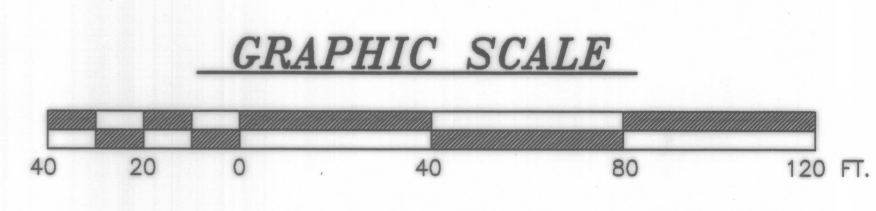

COPYRIGHT

THESE DRAWINGS ARE THE PROPERTY OF THE ENGINEER/SURVEYOR AND HAVE BEEN PREPARED FOR THE OWNER, FOR THIS PROJECT AT THIS SITE AND ARE NOT TO BE USED FOR ANY OTHER PURPOSE, LOCATION OR OWNER WITHOUT WRITTEN CONSENT OF THIS OWNER OR ONE OF ITS DIRECTORS

NO.	DATE	REVISION	BY

SHEET TITLE	BOUNDARY SURVEY PLAN	PROJECT NO.	p00.025
SCALE	1"=40'	DATE	JUNE 7, 2000
PROJECT	PREPARED FOR: NICHOLAS R. & LINDA M. SUPRON 20 FORE ROYAL COURT - JAMESTOWN, R.I.	DRAWN BY	RSL
		CHECKED BY	LRS
		FILENAME	00025s1

WATERMAN ENGINEERING CO.
CIVIL ENGINEERS - SURVEYORS
EAST PROVIDENCE RHODE ISLAND

1 of 1 SHTS