

Lot 410
Lois Smith

Lot 448
Plat 5

Locus

Lot 437
Frank Meyer

Lot 1
Area = 5.05 Acres

Lot 448
Zoned R 80

Lot 2
Area = 5.30 Acres

Lot 478
G. Hodges, Jr.

Atlantic Circle
Area = 8127.53 sq. ft.

Lot 449
S. Myles Gladding

Lot 485
Lois Armbrust

Lot 409
Bruce Hopkins

Lot 473
B.L. Hopkins Construction Co.

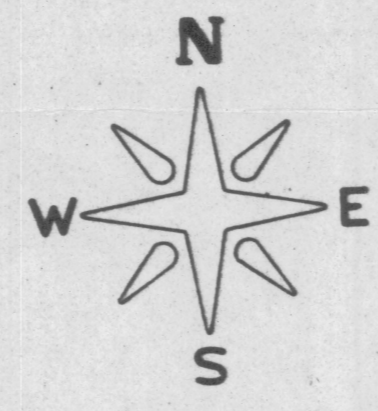

- Legend**
- - - Existing Contour
 - CM Bound Indicated by Chisel Mark
 - GB Bound Indicated by Granite Monument

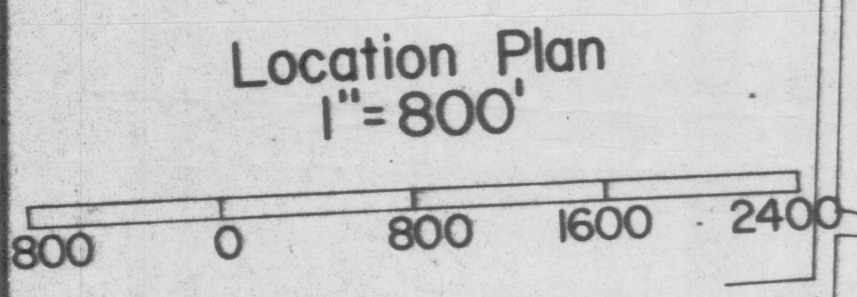
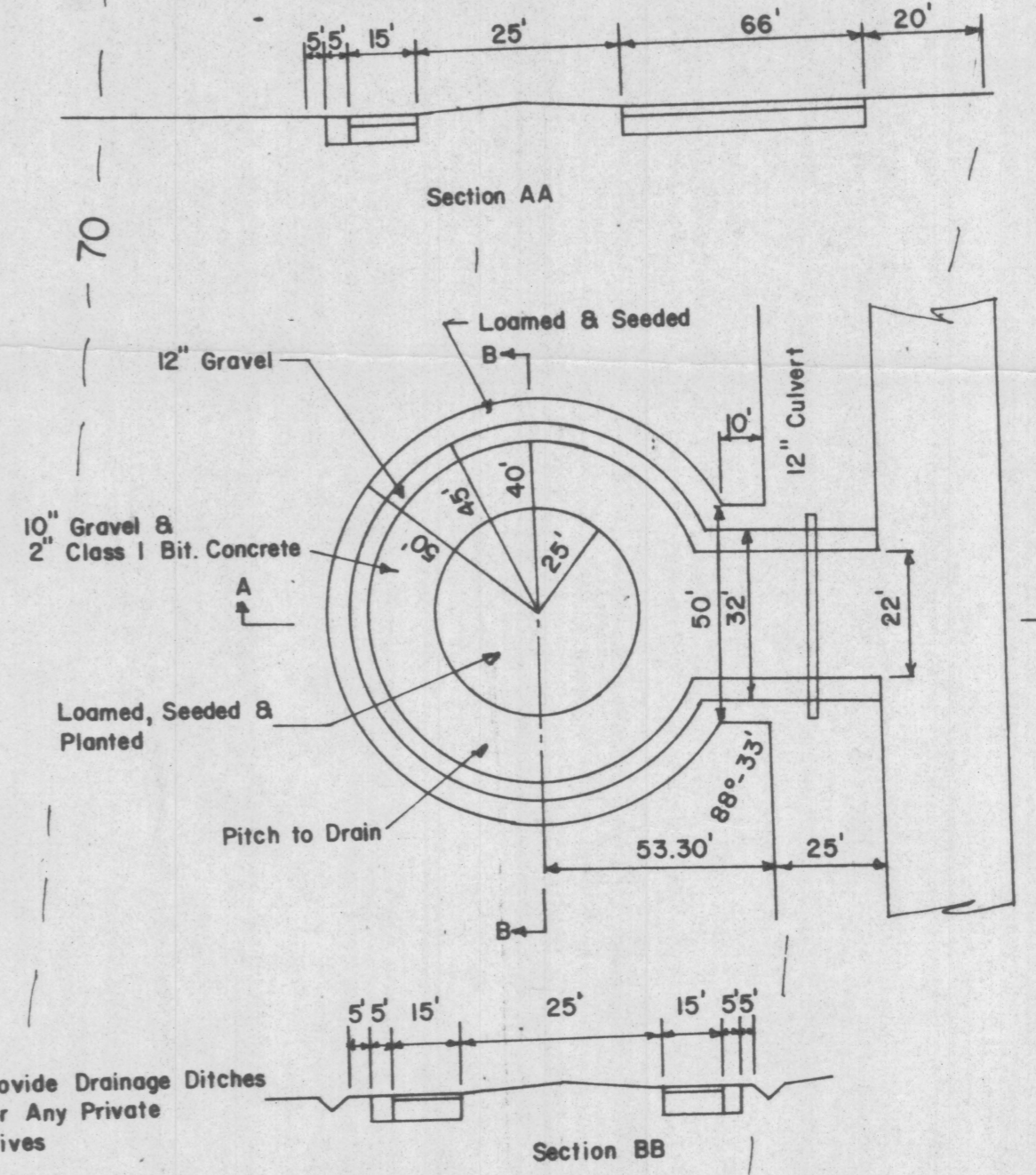

Conanicut Heights Subdivision

SCALE: 1" = 40'
DATE: June 1976

APPROVED BY: PETER L. RYAN
REGISTERED PROFESSIONAL ENGINEER
NO. 3372

DRAWN BY: R. Mucci & T. Quinn
REVISIONS: [Blank]

DRAWING NUMBER: 7633

Approved Jamestown Planning Commission
July 13, 1976 by Robert J. Broadhead, Chairman

Paved Surface Approximately 20' Wide
Highway Line
Stone Wall
North Main Road