

INST # 11347

HPF 108 A

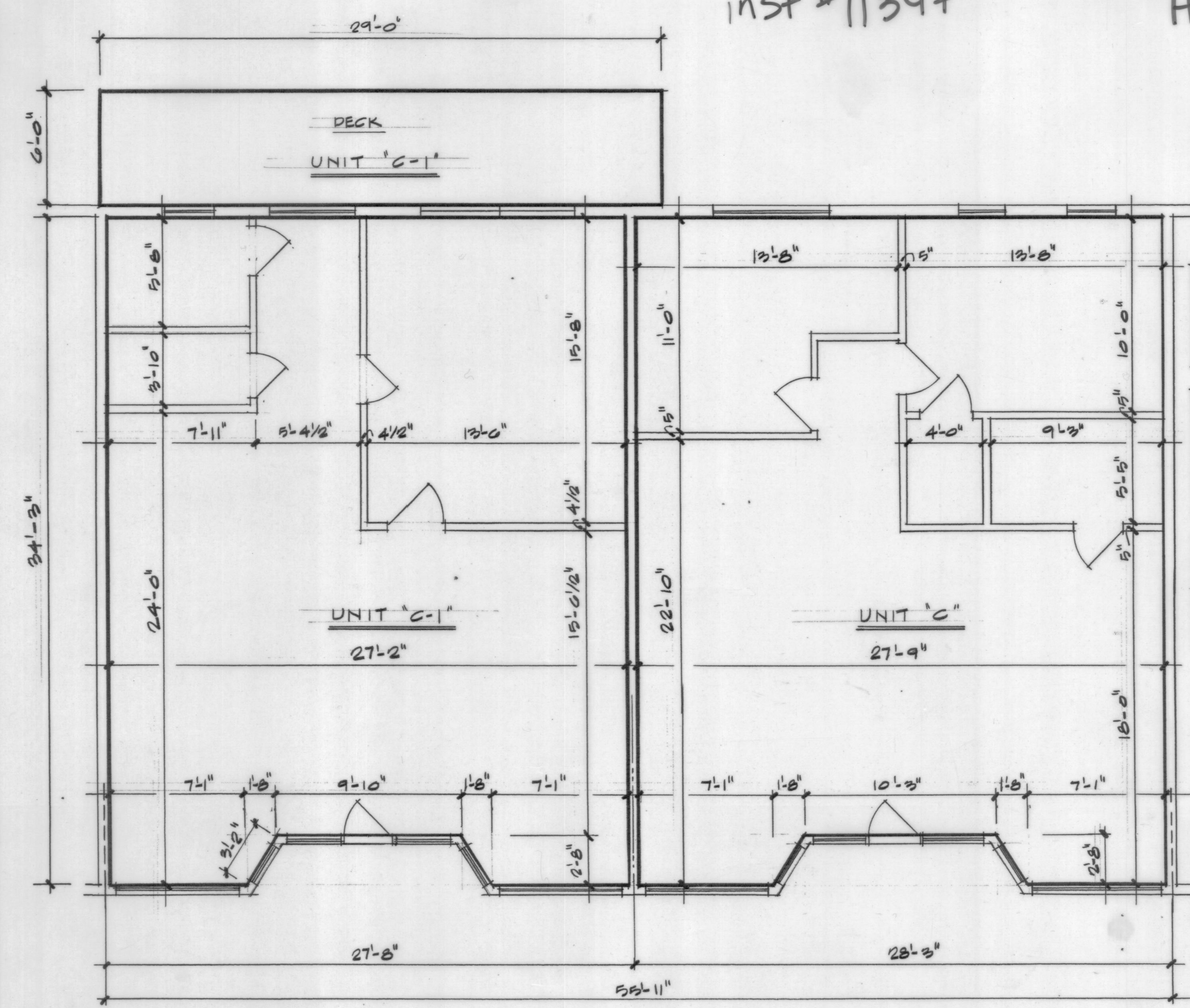

	UNIT "C"	UNIT "C-1"
FLOOR AREA	919 S.F.	899 S.F.
DECK AREA		174 S.F.
FIN. FLR. ELEV.	10.31'	10.31'
FIN. C/G. ELEV.	19.92'	19.92'

THIS IS AN AMENDED PLAN SHOWING THE FOLLOWING CHANGES: THE CREATION OF NEW UNIT "C-1" BY THE DIVISION OF UNIT "C" INTO 2 UNITS. THE CONDOMINIUM NOW COMPRISES 6 UNITS.

TO THE BEST OF MY KNOWLEDGE THIS PLAN IS CORRECT AND CONTAINS ALL INFORMATION REQUIRED BY R.I. CONDOMINIUM LAW STATUTE 34-36.1-2.09

FERRY WHARF CONDOMINIUM EAST
JAMESTOWN RI
FERRY WHARF



DATE: 10/30/00
REVISIONS:

© COPYRIGHT
Ownership and Use of Documents: These drawings are the property of the Architect and have been prepared for the owner for this project in this state and are not to be used, in whole or in part, for any other purpose, location or owner without written consent of the Architect.

DECLARANT:
MERIDETH &
CLARKE INC.

PLAN
1/4" = 1'-0"
BASE PLAN SOURCE:
PLAN BY G. SHEPKEY
DATED 12.9.90

Received for record in Jamestown, RI
DEC 21, 2000 at 11:32 AM
Peter Wold
32.

Estes/ Twombly
ARCHITECTS, INC.
79 THAMES STREET
NEWPORT RI 02840
TEL: 401.846.3336
FAX: 401.848.2818
WWW.ESTESTWOMBLY.COM