

HPF 151B

NOTE: SURVEY AND PLAN CONFORM TO A CLASS STANDARD SPECIFICITY OF PROFESSIONAL LAND SURVEYORS.

ZONING DISTRICT R-80

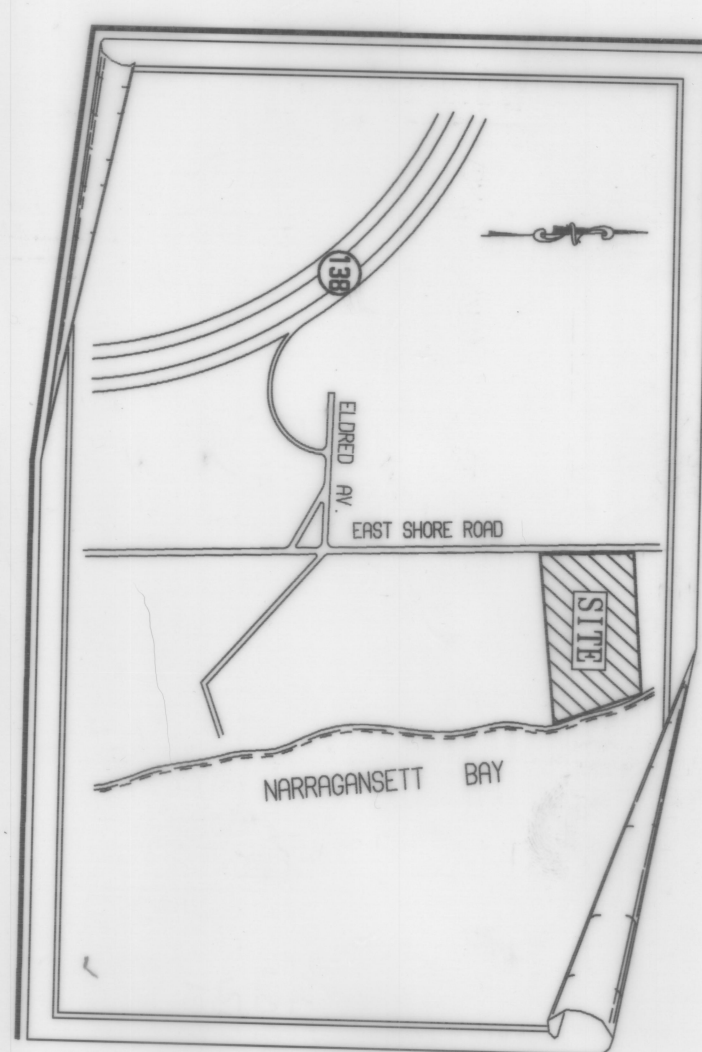

LOCUS PLAN

OWNER:
HARRY F. KURZ & GLORIA J. SCOTT-KURZ
308 EAST SHORE ROAD
JANESTOWN, RHODE ISLAND
LOTS 11 & 49 AS SHOWN ON R.P. 4

DATE	BY	REVISIONS
DECEMBER 11, 1989	JAN	

SURVEY AND DIVISION OF LAND PREPARED FOR
HARRY F. KURZ
AND
GLORIA J. SCOTT-KURZ

308 EAST SHORE ROAD
JANESTOWN, RHODE ISLAND
DATE: NOVEMBER 1, 1989
SCALE 1" = 30'

UDM
Uniform Digital Mapping, Inc.

14 Inland Place
Suite 503
Providence, RI
Corrective Plan

TOWN OF JANESTOWN
FINAL APPROVAL
ADMINISTRATIVE SUBDIVISION
DATE: December 14, 1999
BY: *Mark W. Dwyer*
Title: Administrator
original recorded on

Recorded for record in Janestown, R.I. on **Dec. 14, 1999** at **3:49 PM** by *Mark W. Dwyer*, Town Clerk

JOHN D. ANDREWS
No. 1885
LAND SURVEYOR

1 JAN 1 1980
899



EAST SHORE ROAD
(PUBLIC - WIDTH VARIES)



Notes:
1. There are no wetlands involved with this land being transferred.
2. Instead of this plan it is above a transfer of land above a transfer of land from Lot 11 to Lot 49; producing Lot 11 to 80000 sq. ft. and increasing Lot 49 to 146058 sq. ft.

HPF 151B