

| FED. ROAD DIV. NO. | STATE | FEDERAL AID PROJECT NO. | FISCAL YEAR | SHEET NO. | TOTAL SHEETS | RHODE ISLAND DEPARTMENT OF TRANSPORTATION |  |
|--------------------|-------|-------------------------|-------------|-----------|--------------|---|--|
| 1                  | R.I.  |                         |             | 4         | 7            |   |  |

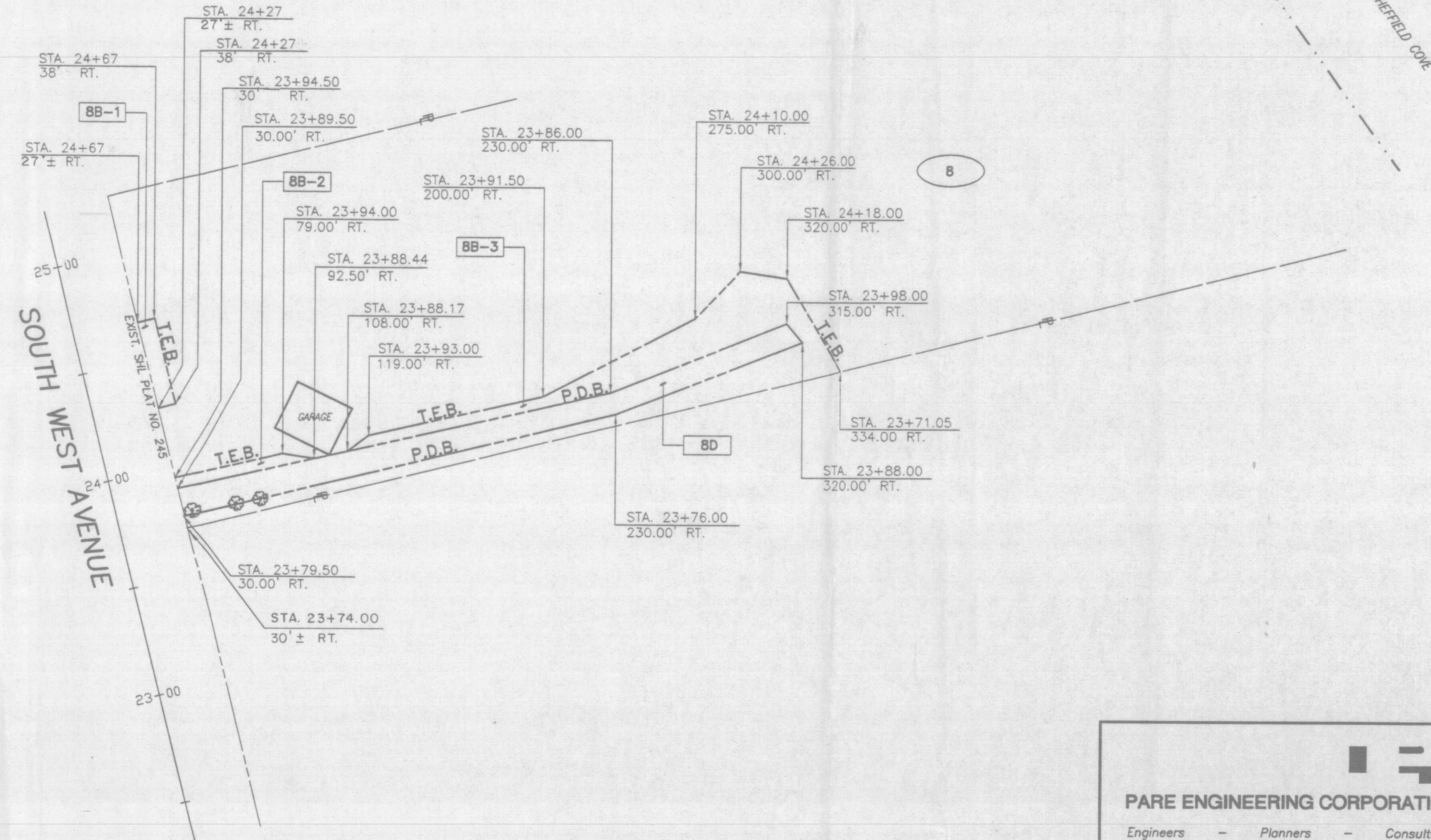
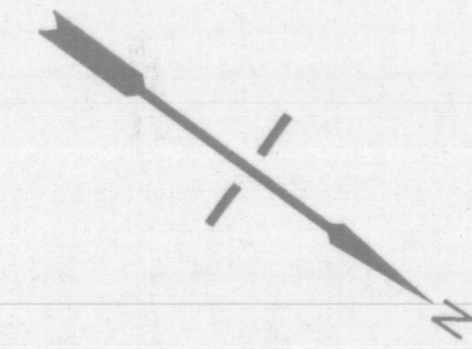

(8) (9/674)  
N/F RICHARD C. CASEY

|      |            |
|------|------------|
| BT   | 2.30 AC ±  |
| 8B-1 | 440 S.F.±  |
| 8B-2 | 288 S.F.±  |
| 8B-3 | 4864 S.F.± |
| 8D   | 3208 S.F.± |
| BR   | 2.30 AC ±  |

**PAPE ENGINEERING CORPORATION**  
 Engineers - Planners - Consultants  
 8 Blackstone Valley Place, Lincoln, RI 02865  
 401/334/4100 Fax: 401/334/4108

JOHN P. SHEVLIN  
 No. 11-97  
 REGISTERED PROFESSIONAL ENGINEER

JAMESTOWN  
**SOUTHWEST AVENUE/BEAVERTAIL ROAD**  
 FROM NARRAGANSETT AVE. TO BATTERY LANE  
**PLAT No. 245C**

...7... SHEETS SHEET NO. ...4...  
**Plat No. 245C**