

JAMESTOWN INN CONDOMINIUMS
JAMESTOWN RI
PHASE 1

JOB NO. 2811
DATE 7/89
FIRST FLOOR PLAN

A2



William L. Burgin, Architects
150 Bellevue Avenue, Newport, R.I. 02840
401.847.3339

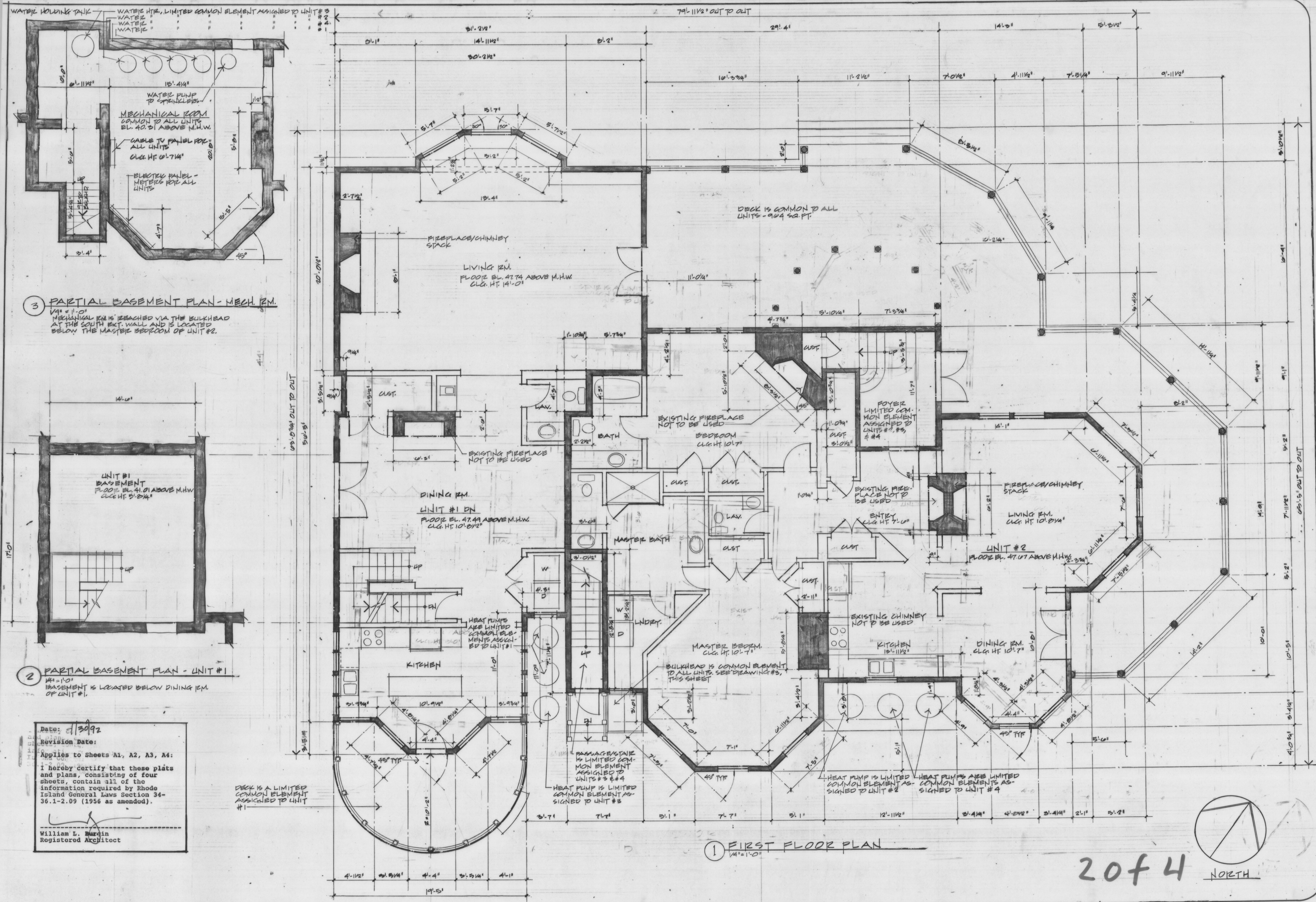

3 PARTIAL BASEMENT PLAN - MECH. RM.

Mechanical RM is reached via the bulkhead at the south ext. wall and is located below the master bedroom of unit #2.

2 PARTIAL BASEMENT PLAN - UNIT #1

Unit #1 basement is located below dining rm of unit #1.

Date: 7/30/92
Revision Date:
Applies to Sheets A1, A2, A3, A4:
I hereby certify that these plans and plans, consisting of four sheets, contain all of the information required by Rhode Island General Laws Section 34-36.1-2.09 (1956 as amended).
William L. Burgin
Registered Architect

1 FIRST FLOOR PLAN

20 of 4

