

CONV. NO.	LS (FT)	CS	TL (FT)	TS (FT)	NORTH	EAST	7/81	CONV. NO.	LENGTH (FT)	LENGTH (FT)	NORTH	EAST	NORTH	EAST
SP-2	400		7°-29'-23"	266.91	133.55	160248.484	536144.789	5	1530	985.29	69° 33' 41.8"	1750.73	159844856	534662.959
								6	2350	350.90	16° 59' 6.3"	696.65	158669.192	534092.460

CONV. NO.	LENGTH (FT)	LENGTH (FT)	NORTH	EAST	NORTH	EAST
5	1530	985.29	69° 33' 41.8"	1750.73	159844856	534662.959
6	2350	350.90	16° 59' 6.3"	696.65	158669.192	534092.460

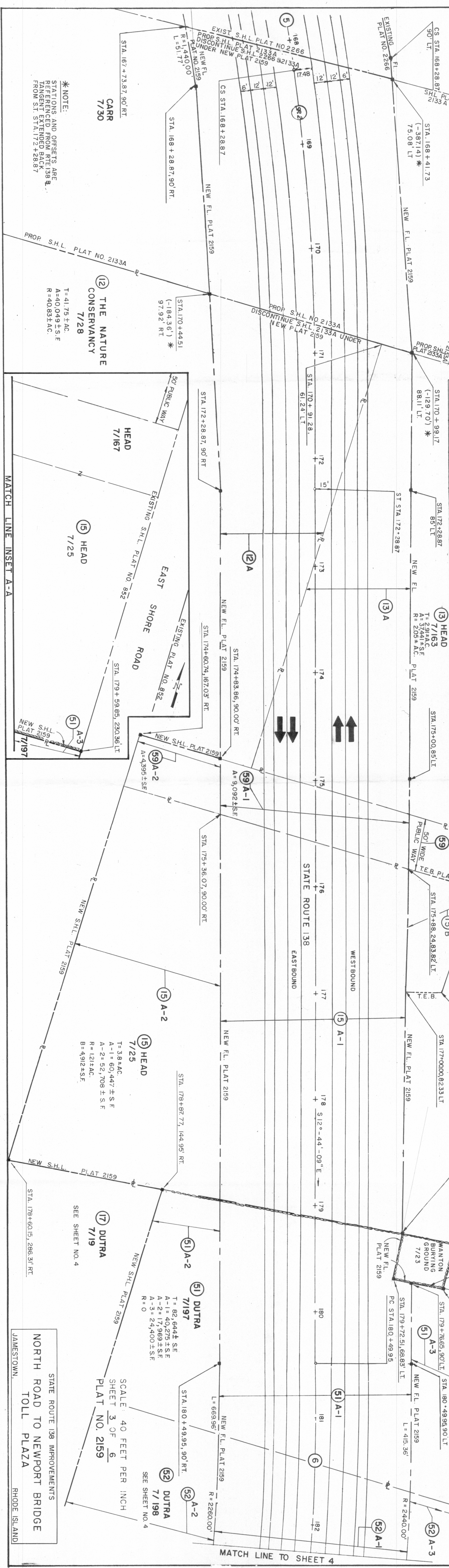

* NOTE:
STATIONS AND OFFSETS ARE
REFERENCED FROM RTE 138
TANGENT EXTENDED BACK
FROM S.T. STA. 172+28.87

12 THE NATURE
CONSERVANCY
7/28
T=41.75±AC.
A=40.049±S.F.
R=40.83±AC.

13 HEAD
7/163
T=29±AC.
A=3744±S.F.
R=205±AC.

15 HEAD
7/25
T=3.8±AC.
A-1=60.447±S.F.
A-2=52.708±S.F.
R=121±AC.
B=4912±S.F.

17 DUTRA
7/19
SEE SHEET NO. 4

51 DUTRA
7/197
T=82.644±S.F.
A-1=40.275±S.F.
A-2=17.969±S.F.
A-3=24.400±S.F.
R=0

SCALE: 40 FEET PER INCH
SHEET 3 OF 6
PLAT NO. 2159

STATE ROUTE 138 IMPROVEMENTS
NORTH ROAD TO NEWPORT BRIDGE
TOLL PLAZA
RHODE ISLAND
JAMESTOWN

RHODE ISLAND
DEPARTMENT OF TRANSPORTATION
DIVISION OF PUBLIC WORKS