

HPF 68A

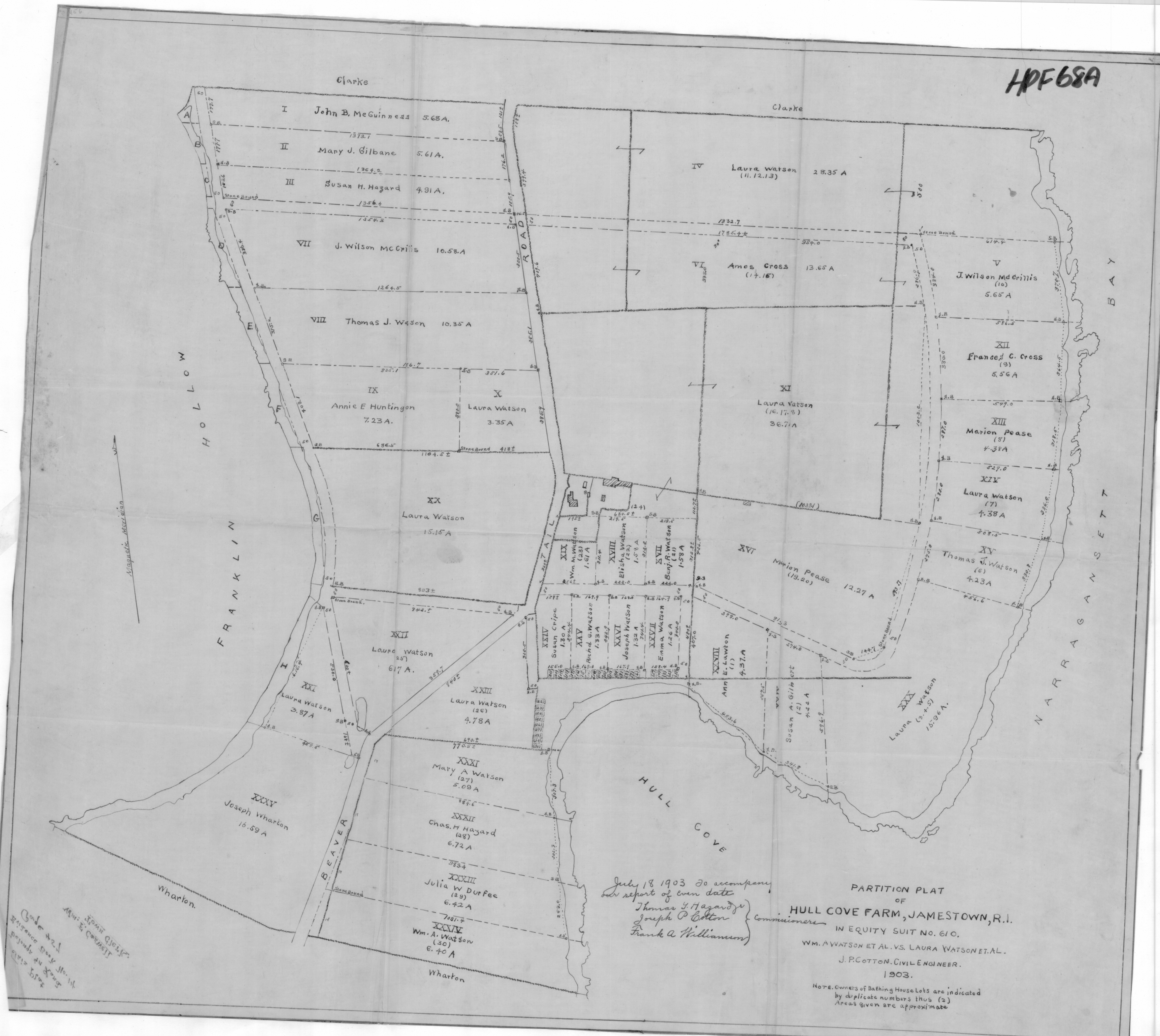

July 18 1903 to accompany
 our report of even date
 Thomas J. Hagar &
 Joseph P. Cotton } Commissioners
 Frank A. Williamson

PARTITION PLAT
 OF
 HULL COVE FARM, JAMESTOWN, R.I.
 IN EQUITY SUIT NO. 610.
 WM. A. WATSON ET AL. VS. LAURA WATSON ET AL.
 J. P. COTTON, CIVIL ENGINEER.
 1903.

Note: Owners of Bathing House Lots are indicated
 by duplicate numbers thus (2)
 Areas given are approximate.

Scale 1/2" = 100'
 Reference to map No. 11
 of 1897
 1897 5794