

STATE HIGHWAY CANONIKUS AVENUE PLAT # 852
(80' WIDE)

THE BAY VOYAGE CONDOMINIUM

KATHRYN L. CASWELL
35/505 54/505

DONALD A. & LOUISE M. RICHARDSON
63/204

PICKETT M. & MARTHA A. GREIG
57/561

AREA PARCEL CONTAINS
49,504 SQ. FT.

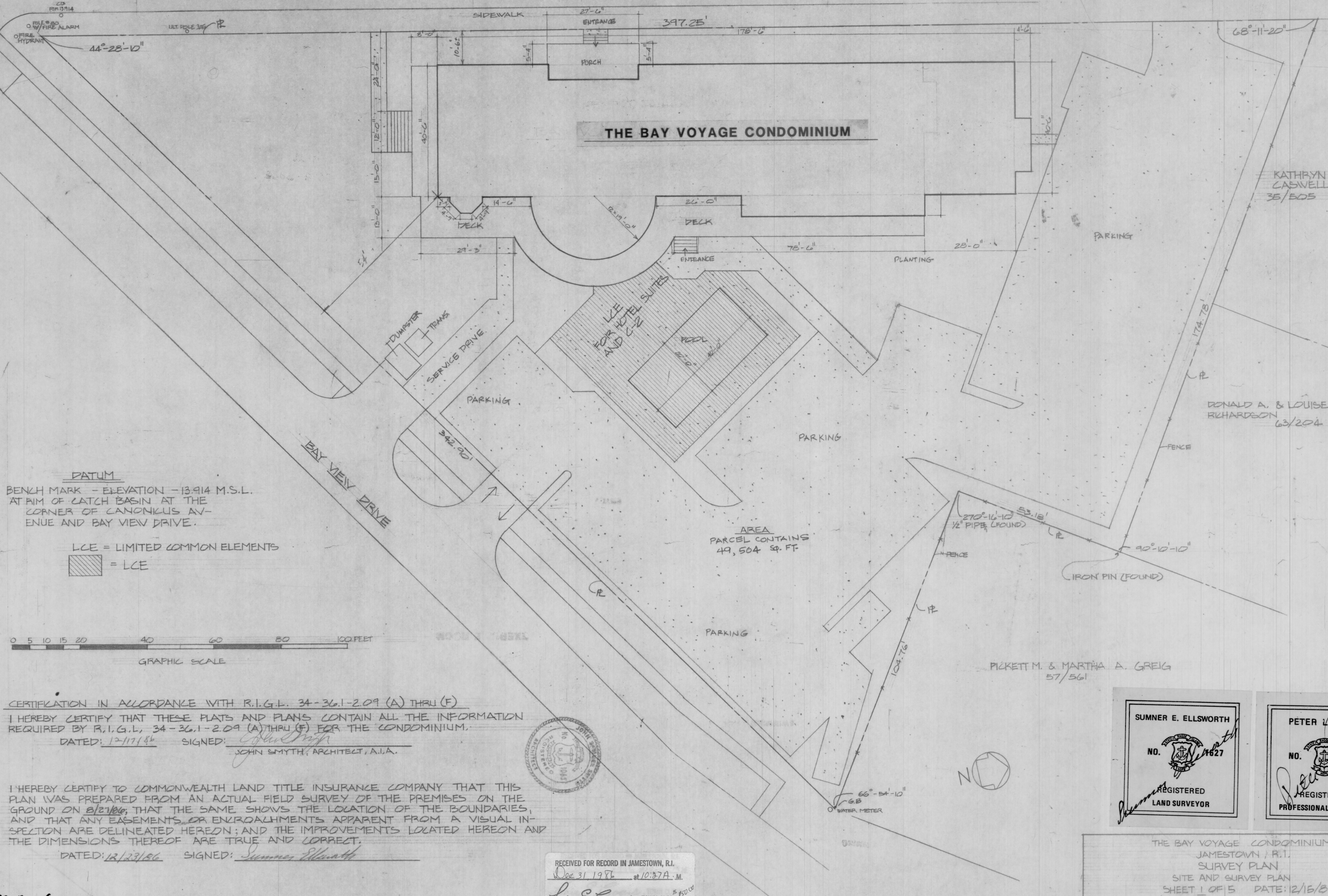

DATUM
BENCH MARK - ELEVATION - 13.914 M.S.L.
AT RIM OF CATCH BASIN AT THE
CORNER OF CANONIKUS AV-
ENUE AND BAY VIEW DRIVE.

LCE = LIMITED COMMON ELEMENTS
[Hatched Box] = LCE

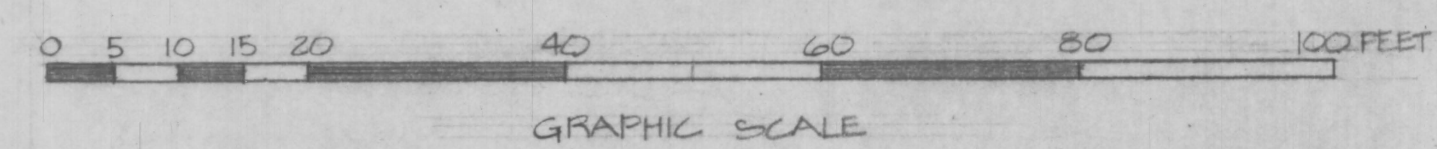

CERTIFICATION IN ACCORDANCE WITH R.I.G.L. 34-36.1-2.09 (A) THRU (F)
I HEREBY CERTIFY THAT THESE PLATS AND PLANS CONTAIN ALL THE INFORMATION
REQUIRED BY R.I.G.L. 34-36.1-2.09 (A) THRU (F) FOR THE CONDOMINIUM.
DATED: 12/17/86 SIGNED: *John Smyth*
JOHN SMYTH, ARCHITECT, A.I.A.



I HEREBY CERTIFY TO COMMONWEALTH LAND TITLE INSURANCE COMPANY THAT THIS
PLAN WAS PREPARED FROM AN ACTUAL FIELD SURVEY OF THE PREMISES ON THE
GROUND ON 8/21/86; THAT THE SAME SHOWS THE LOCATION OF THE BOUNDARIES,
AND THAT ANY EASEMENTS OR ENCROACHMENTS APPARENT FROM A VISUAL IN-
SPECTION ARE DELINEATED HEREON; AND THE IMPROVEMENTS LOCATED HEREON AND
THE DIMENSIONS THEREOF ARE TRUE AND CORRECT.
DATED: 12/23/86 SIGNED: *Sumner E. Ellsworth*

RECEIVED FOR RECORD IN JAMESTOWN, R.I.
Dec 31 1986 at 10:37 A.M.
Lair E. Coons, TOWN CLERK \$150.00

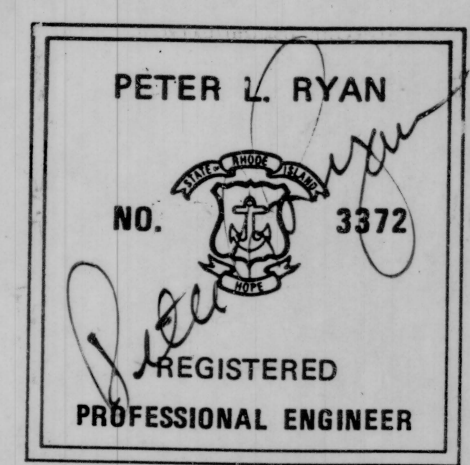
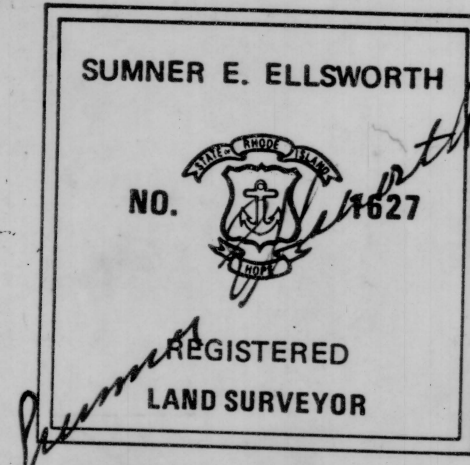

THE BAY VOYAGE CONDOMINIUM
JAMESTOWN, R.I.
SURVEY PLAN
SITE AND SURVEY PLAN
SHEET 1 OF 5 DATE: 2/15/86

HPF42A (BRC9)