



REVISIONS

| | |
|---|------------------|
| A | ESTD 10-4-84 |
| B | REVISED 12-12-84 |
| C | 4-25-85 |

ANY REPRODUCTION, POSSESSION, OR USE OF THIS DRAWING OR ANY PART THEREOF WITHOUT THE WRITTEN PERMISSION OF THE ROBINSON GREEN BERETTA CORPORATION, 2 JOHN STREET, PROVIDENCE, RHODE ISLAND, IS PROHIBITED. VIOLATORS WILL BE PROSECUTED TO THE FULL EXTENT OF THE LAW.

THE ROBINSON GREEN BERETTA CORPORATION
 2 JOHN STREET PROVIDENCE, RHODE ISLAND 02908 401-372-1728
 ARCHITECTURE PLANNING ENVIRONMENT DESIGN DEVELOPMENT



GERHARD H. GRAF
 No. 2704
 REGISTERED PROFESSIONAL ENGINEER

HARBORVIEW CONDOMINIUM
 NORMAN R. BERETTA & CARMINE CARCIERI
 DEVELOPERS
 CONANICUS AVE. JAMESTOWN, R.I.

DWN BY JD
 PA/PE: RJF
 JOB NO: 3027
 ISSUED: 9/23/83

SHEET CONTENTS
 SITE PLAN

THE ROBINSON GREEN BERETTA CORPORATION

C-1
 SHEET OF

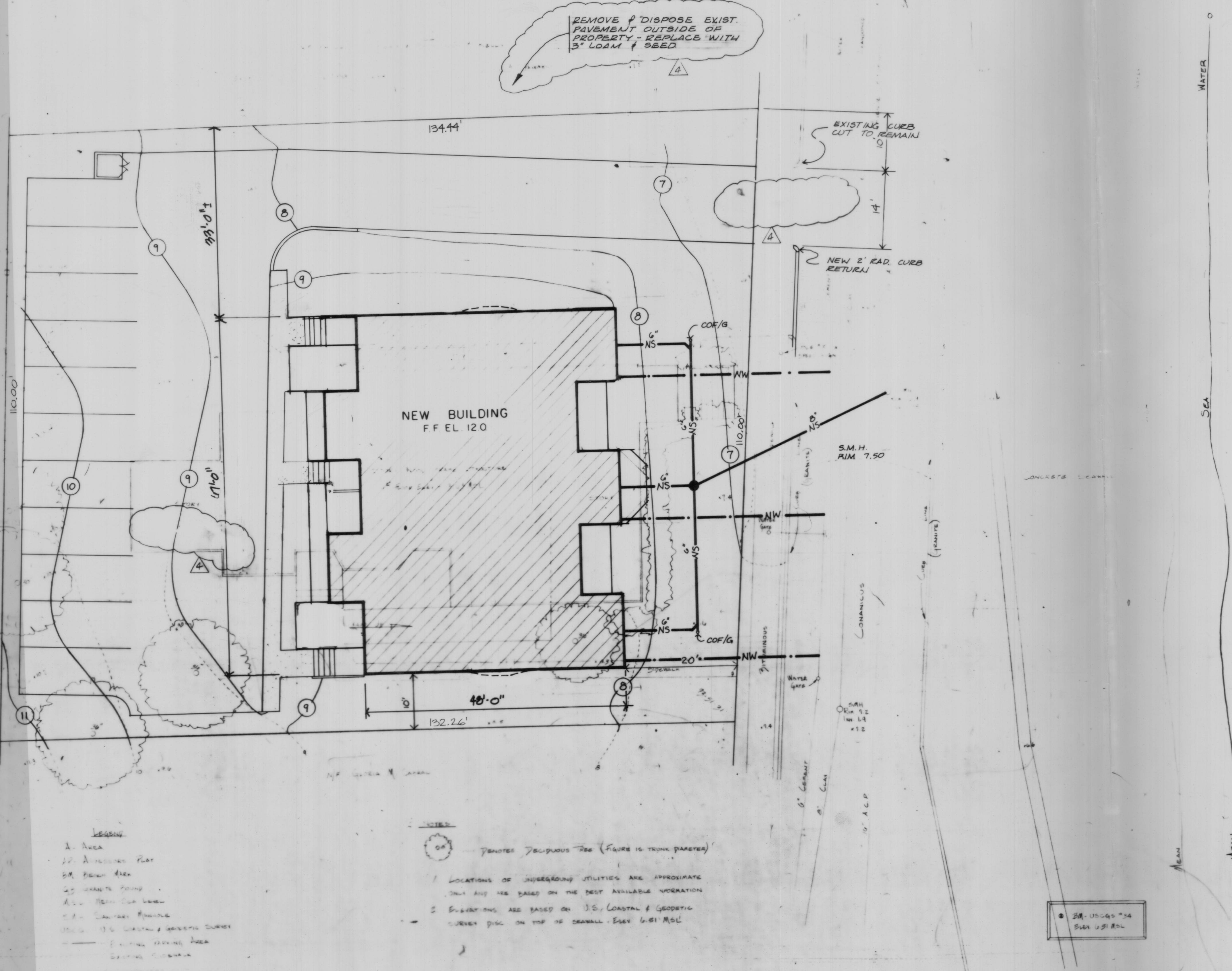

- LEGEND
- 1. Area
 - 2. A. Area
 - 3. A. Area
 - 4. A. Area
 - 5. A. Area
 - 6. A. Area
 - 7. A. Area
 - 8. A. Area
 - 9. A. Area
 - 10. A. Area
 - 11. A. Area

- NOTES
1. LOCATIONS OF SUBGRADING UTILITIES ARE APPROXIMATE ONLY AND ARE BASED ON THE BEST AVAILABLE INFORMATION.
 2. ELEVATIONS ARE BASED ON 3.5' LOCAL & GEODETIC CURVED DISK ON THE 12' ORANGE - ELEV. 4.51' MSL.

CERTIFIED TO BE IN COMPLIANCE WITH THE PROVISIONS OF SECTIONS 34-36.1-2.01 AND 2.02

[Signature]

1987

Received in Jamestown, R. I. for record
 Dec 27 1985
 # M. and recorded
 in Volume 141 of Land Evidence
 of Jamestown, R. I. at page 1
[Signature] Town Clerk

HPF35A+B (BRC.10)