

DATE: 11/10/2010 11:58 AM

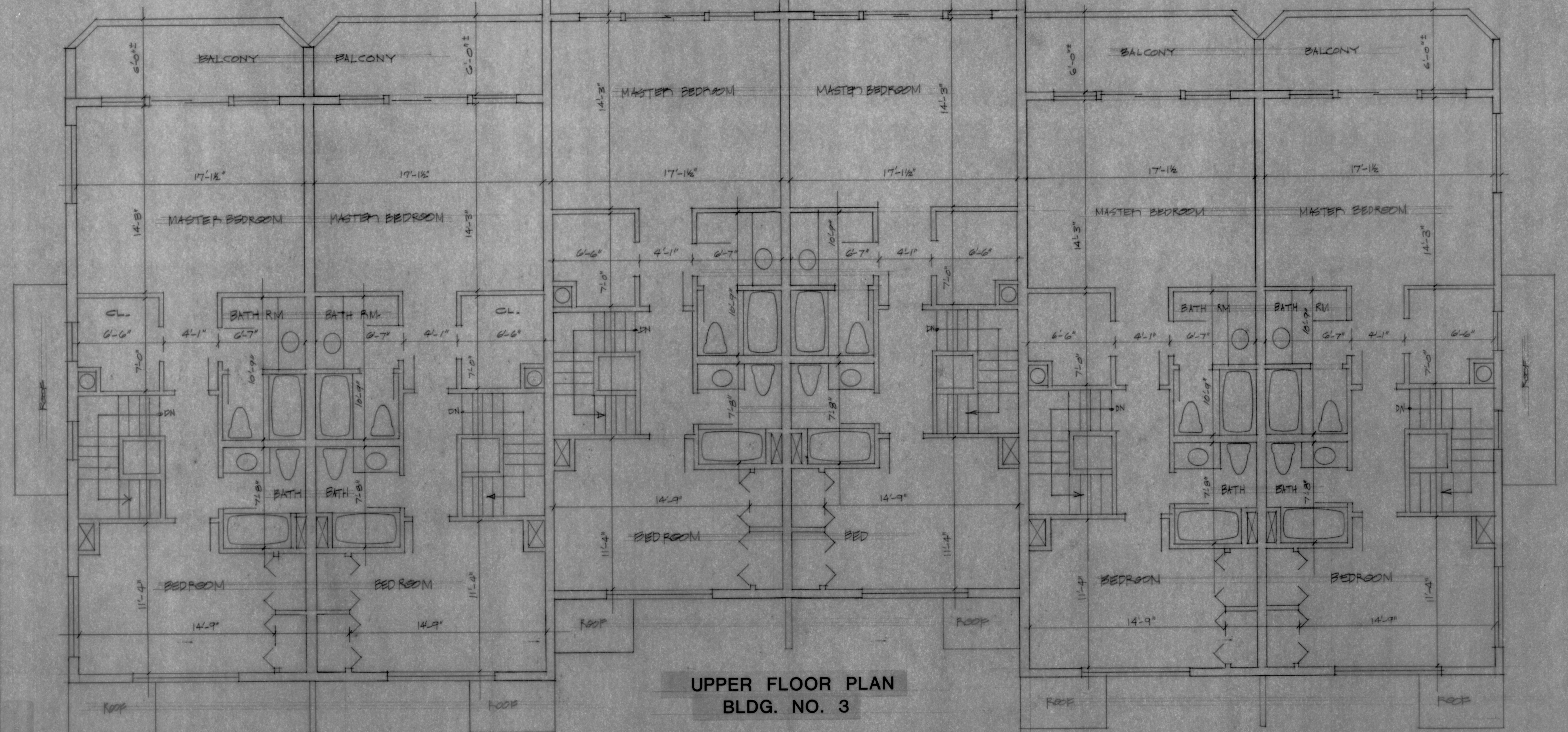

**UPPER FLOOR PLAN
BLDG. NO. 3**

UNIT #14	UNIT #15	UNIT #16	UNIT #17	UNIT #18	UNIT #19
FIN. FL. ELEV. 32.66'	FIN. FL. ELEV. 32.66'	FIN. FL. ELEV. 32.66'	FIN. FL. ELEV. 32.66'	FIN. FL. ELEV. 32.66'	FIN. FL. ELEV. 32.66'
FIN. CLG. ELEV. 40.66'	FIN. CLG. ELEV. 40.66'	FIN. CLG. ELEV. 40.66'	FIN. CLG. ELEV. 40.66'	FIN. CLG. ELEV. 40.66'	FIN. CLG. ELEV. 40.66'

TAYLORS POINT CONDOMINIUM PHASE 2
BAY VIEW DRIVE, JAMESTOWN R. I.

PHASE 2
SHEET 3 OF 3

TAYLORS POINT DEVELOPMENT COMPANY
JOHN SMYTH ARCHITECT

HPF 33B (BRC11)