

JAMESTOWN, RHODE ISLAND
Tax Assessor's Plat 7, Lot 66

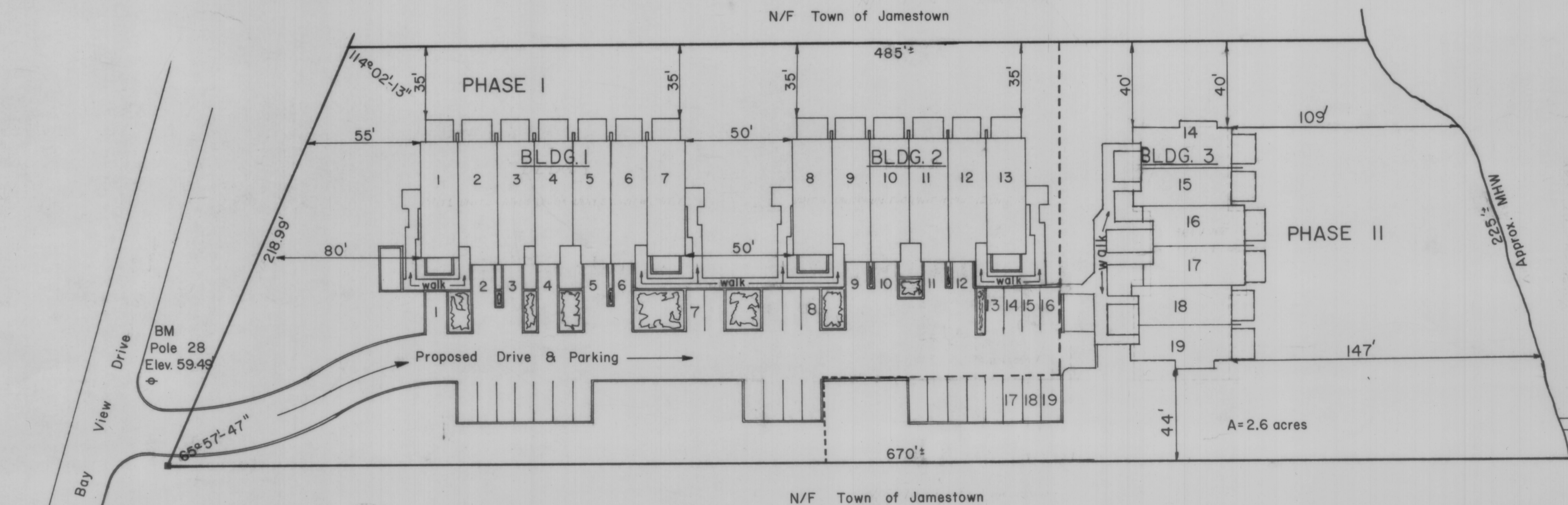

LEGEND
BM - BENCH MARK
MHW - MEAN HIGH WATER
N F - LAND NOW OR FORMERLY OF
--- PHASE LINE
← - BUILDING SET BACK

Proposed
Fixed Dock (Phase II)
40' x 6'

Size & Location Approximate Only
Subject to Local, State & Federal Approvals

**AMENDED
SITE PLAN**
TAYLORS POINT CONDOMINIUM
TAYLORS POINT DEVELOPMENT COMPANY
Bay View Drive, Jamestown, R.I.

SCALE 1"=40'

By: Island Engineering, March, 1981
AMENDED: OCTOBER 1982

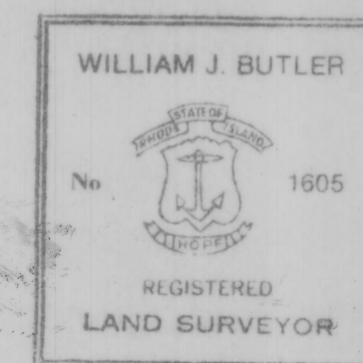

SHEET 1 of 3 SHEETS

Recorded in the Office of the Registrar of Deeds for the State of Rhode Island, Providence, R.I., on March 14, 1982 at 2:16 p.m.
P.L.R.
of Land Existence
of Department, R.I. on page

HPF32-B (BRC11)

1500