

Taylor's Point

CONSENT

KNOW ALL MEN BY THESE PRESENTS, that TAYLORS POINT DEVELOPMENT COMPANY, the record owner of the land shown on survey map, hereby consents to the recording of this survey map, pursuant to Section 34-36-13 of the General Laws of Rhode Island 1956, as amended.

IN WITNESS WHEREOF, TAYLORS POINT DEVELOPMENT COMPANY has caused these presents to be executed by Herbert L. Finley, its President, hereunto duly authorized, this 1st day of April, A. D. 1982.

WITNESS: TAYLORS POINT DEVELOPMENT COMPANY
By *Herbert L. Finley*
Herbert L. Finley
President

STATE OF RHODE ISLAND
COUNTY OF NEWPORT
In Newport, on the 1st day of April, A. D. 1982, before me personally appeared HERBERT L. FINLEY, to me known and known by me to be the President of TAYLORS POINT DEVELOPMENT COMPANY, and the party executing the foregoing instrument, and he acknowledged said instrument by him executed to be the free act and deed of TAYLORS POINT DEVELOPMENT COMPANY and his free act and deed as President aforesaid.

Before me,
Andrew M. Brown, Jr.
Notary Public
Andrew M. Brown, Jr.



JAMESTOWN, RHODE ISLAND
Tax Assessor's Plat 7, Lot 66

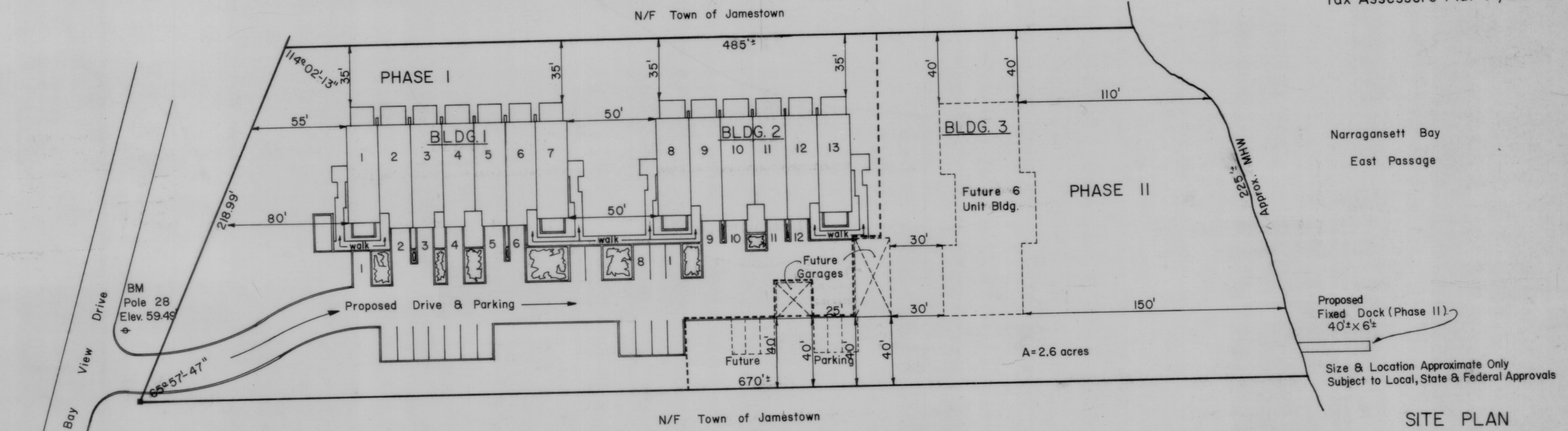

LEGEND

- BM - BENCH MARK
- MHW - MEAN HIGH WATER
- N F - LAND NOW OR FORMERLY OF
- PHASE LINE
- BUILDING SET BACK

SITE PLAN
TAYLORS POINT CONDOMINIUM
TAYLORS POINT DEVELOPMENT COMPANY
Bay View Drive, Jamestown, R.I.

SCALE 1"=40'
By: Island Engineering, March, 1981

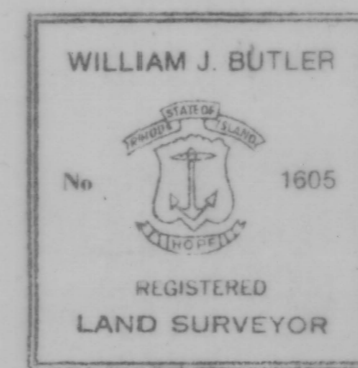

HPF 31A (BRC12)